

HENRI^{The Path to Color} MATISSE:

マティス展

2023.4.27(thu)–8.20(sun)  東京都美術館
TOKYO METROPOLITAN ART MUSEUM

Organized by: Tokyo Metropolitan Art Museum operated by Tokyo Metropolitan Foundation for History and Culture, The Centre Pompidou, The Asahi Shimbun, NHK, NHK Promotions Inc.

Supported by: Embassy of France in Japan / Institut français du Japon

With the Special Sponsorship of: **Daiwa Securities Group**

Sponsored by: DAIKIN INDUSTRIES, LTD., Daiwa House Industry Co., Ltd., Nissha Co., Ltd.

In Cooperation with: JAPAN AIRLINES

Centre
Pompidou 

Notes

· Temperature, humidity, and lighting in the gallery are strictly controlled for the conservation of works under the provisions of international standards and the lender's condition of loan. We apologize for any inconvenience this may cause.

· Photography is permitted only in a designated area. Please refrain from video shooting and using flashes or equipment such as tripods or selfie sticks. For the preservation of the viewing environment, the areas where photography is permitted may be cancelled or interrupted without prior notice.

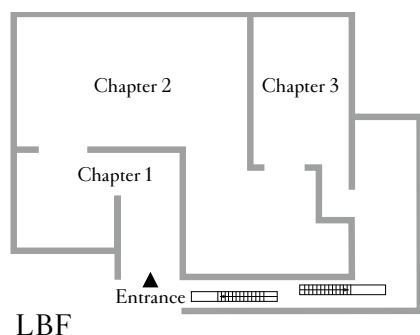

LBF

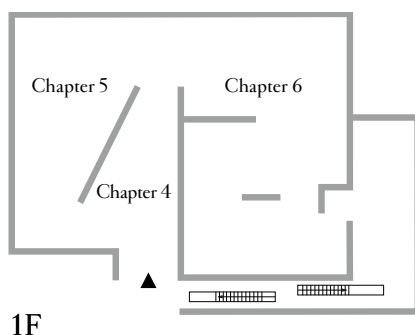

1F

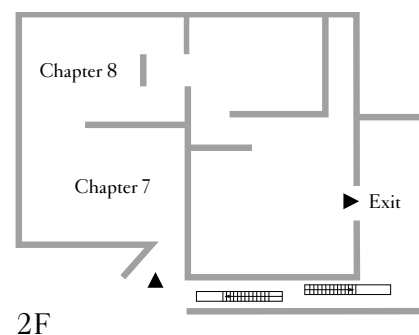

2F

Notes

· Notations used in this list of works follow the order: catalogue number, title, date, materials and techniques, photographer, dimensions, owner.

· Unless otherwise specified, all the works are from the collection of the Centre Georges Pompidou, Musée national d'art moderne, Paris.

· The order of the work in this list may not necessarily correspond to that in the gallery.

1. Towards Fauvism 1895–1909

1 Woman Reading

Winter 1895
Oil on panel
61.5×48cm
On long-term loan to Musée départemental Matisse, Cateau-Cambrésis

2 Belle-Isle

1896
Oil on canvas
46×38cm
On long-term loan to Musée des Beaux-Arts, Bordeaux

3 Jaguar Devouring a Hare, after Barye

1899–1901
Bronze (cast 1953, black patina)
22.5×56×22.4cm
On long-term loan to Musée Matisse, Nice

4 Self-Portrait

1900
Oil on canvas
55×46cm

5 Pont Saint-Michel

c. 1900
Oil on canvas
58×71cm

6 Still Life with Chocolate Pot

1900–02

Oil on canvas

73×60cm

7 Portrait of Bevilacqua

1901–03
Oil on canvas
35.5×27cm
On long-term loan to Musée des Beaux-Arts, Bordeaux

8 Madeleine II

1903
Bronze (cast 1953, dark patina)
59.5×18.5×20cm

9 Landscape at Collioure

c. 1905–06
Oil on panel
40.5×32cm
Collection of Menard Art Museum

10 Luxe, calme et volupté

Autumn–Winter 1904
Oil on canvas
98.5×118.5cm
On long-term loan to Musée d'Orsay, Paris

11 Reclining Nude I

1907
Bronze (cast 1908, dark patina)
35.5×50.5×28cm

12 Le Luxe I

Summer 1907
Oil on canvas
210×138cm

13 Study for *Le Luxe I*

1907
Graphite lead on sheet of laid paper
19×14cm

14 Study for *Le Luxe I*

1907
Carré Conté Crayon on ruled paper
20.7×13cm

15 Study of Reclining Nude

1910–11
Graphite on paper
25.5×35.4cm

16 Nude Seen from Behind

1907–08
Indian ink on wrapping paper
38.6×18.6cm

17 Two Negresses

1907
Bronze (cast 1952, dark patina)
49.5×28×20cm

18 Seated Nude, Arm Behind Her Back

1909
Bronze (cast c. 1910, black patina)
29.5×17×23cm

19 Head of Little Girl Marguerite

1906
Bronze (cast before 1936, dark matte patina)
20×18×14.5cm
On long-term loan to Musée de Grenoble

20 Study of Foot

1909
Bronze (cast 1958)
29.8×20×15.2cm
On long-term loan to Musée de Grenoble

21 Algerian Woman

Spring 1909
Oil on canvas
81×65cm

2. The Radical Years 1914–18

22 Interior, Goldfish Bowl

Spring 1914
Oil on canvas
147×97cm

23 French Window at Collioure

September–October 1914
Oil on canvas
116.5×89cm

24 The Painter in His Studio

end of 1916–beginning of 1917
Oil on canvas
146.5×97cm

25 The Violinist at the Window

Spring 1918
Oil on canvas
150×98cm

26 White and Pink Head

Autumn 1914
Oil on canvas
75×47cm

27 Portrait of Greta Prozor

end of 1916
Oil on canvas
146×96cm

28 Portrait of Auguste Pellerin II

May 1917
Oil on canvas
150.2×96.2cm

29 Still Life with Ivy

1916
Oil on canvas
60×73cm
On long-term loan to Musée des Beaux-Arts et d'Archéologie, Besançon

3. A Parallel Search 1913–30

30
Jeannette I
Summer 1910
Bronze (cast c. 1930, dark patina)
32.2×22.3×26cm

31
Jeannette IV
1911
Bronze (cast before 1936, dark patina)
61×23.5×27.5cm

32
Henriette I
1925
Bronze (cast 1965, dark brown patina)
28.6×19.5×25.3cm
On long-term loan to Musée des Beaux-Arts, Dijon

33
Henriette II
1927
Bronze (cast c. 1930, dark patina)
32.5×22×29cm

34
Henriette III
1929
Bronze (cast 1958, dark brown patina)
40.5×21.5×23cm
On long-term loan to Musée des Beaux-Arts, Dijon

35
The Back I
1909
Bronze (cast 1956, dark brown patina)
190×116×17cm

36
The Back II
1913
Bronze (cast 1964, dark golden brown patina)
188×116×14cm

37
The Back III
1916–17
Bronze (cast 1964, dark patina)
190×114×16cm

38
The Back IV
1930
Bronze (cast c. 1960–63, dark brown patina)
190×114×16cm

4. Figures and Interiors 1918–29

39
Self-Portrait
1927
Graphite on paper
22.7×17.4cm

40
Self-Portrait with Pipe
1919
Indian ink on paper pasted on cardboard
37×27.5cm
On long-term loan to Musée des Beaux-Arts et d'Archéologie, Besançon

41
Portrait of André Rouveyre
1912
Charcoal and *estompe* on paper
41×28cm

42
Spanish Woman with a Fan
1923
Charcoal and *estompe* on Arches paper
51×40.2cm

43
Half-Naked Woman Standing
1923–24
Charcoal and *estompe* on paper
47.6×31.5cm

44
Young Violinist in Front of a Piano
1924–26
Charcoal and *estompe* on Ingres d'Arches paper
47.5×62.5cm

45
Young Spanish Woman
1921
Oil on canvas
56×26cm
On long-term loan to Musée des Beaux-Arts, Bordeaux

46
Portrait of a Young Woman
c. 1925
Oil on cardboard
40×16cm
On long-term loan to Musée des Beaux-Arts, Bordeaux

47
Landscape
1915
Graphite on wove paper
28×21.8cm

48
House and Trees
1918
Graphite lead on paper
33.6×25.9cm

49
Trees
1921–25
Graphite on PM Fabriano wove paper
37×27.5cm

50
Odalisque with Red Trousers
Autumn 1921
Oil on canvas
65.3×92.3cm

51
Interior in Nice, a Siesta
c. January 1922
Oil on canvas
66×54.5cm

52
Portrait of Baroness Gourgaud
1924
Oil on canvas
81×65cm
On long-term loan to Musée des Arts Décoratifs, Paris

53
Still Life with Plaster Torso
1927
Oil on canvas
52×64cm
Collection of Artizon Museum, Ishibashi Foundation, Tokyo

54
Still Life with a Green Sideboard
1928
Oil on canvas
81.5×100cm

5. Expansion and Experiment 1930–37

55
The Dream
May 1935
Oil on canvas
81×65cm

56
Study for *The Dream*
1935
Graphite lead on paper
24.8×32.3cm

57
Venus in a Shell
1930
Bronze (cast 1951, dark patina)
34.5×20.6×21.5cm

58
Seated Pink Nude
April 1935–36
Oil on canvas
92×73cm

59
Nude with Arms Raised
1930–33
Graphite on wove paper
32.1×24.7cm

60
Nude
1930–31
Graphite lead on paper
28×21.6cm

61
Lisette with a Turkish Armchair
1931
Ink on Vélín d'Arches paper
28.3×38cm

62
Small Blue Dress Before a Mirror
1937
Oil on canvas
64×49cm
Collection of The National Museum of Modern Art, Kyoto

6. From Nice to Venice 1938–48

63
La France
1939
Oil on canvas
44.8×36.7cm
Collection of Hiroshima Museum of Art

64
Still Life with Green Marble Table
September 1941
Oil on canvas
46×38.5cm

65
Still Life with a Magnolia
December 1941
Oil on canvas
74×101cm

66
Still Life
July 1944
Indian ink on paper
56.3×43.5cm

67
Iris Blossoms
1941–42
Soft pencil on wove paper
26.9×21cm

68
Head of Woman
1941
Ink on paper
20×26cm

69
Woman's Face (Starry Veil) L5
1942
Soft pencil on wove paper
33×51.7cm

70
Sleeping Woman
1942
Charcoal on paper
29×40.5cm
On long-term loan to Musée des Beaux-Arts et d'Archéologie, Besançon

71
Dessins: thèmes et variations
(Paris: Martin Fabiani, 1943),
foreword by Louis Aragon
« Matisse-en-France »
1943
Book
33.5×25.5cm
Collection of Centre Pompidou, Mnam-Cci, Bibliothèque Kandinsky, Paris

72
Themes and Variations E10
1941
Indian ink on PM Fabriano wove paper
56.6×38cm

73
Self-Portrait with Straw Hat
1945
Ink on paper
40.1×26cm

74
Self-Portrait
1937
Charcoal on paper mounted on laid paper
25.4×20.3cm

75
Aragon
1942
Ink on Arches paper
52.9×40.5cm

76
Portrait of Professor Leriche
1949
Charcoal and *estompe* on Arches paper
38.4×27.2cm

77
Colette
1950
Charcoal and *estompe* on Arches paper
40.4×33cm

78
Young Woman with a White Fur Cloak
1944
Oil on canvas
73×60cm
On long-term loan to Musée de Grenoble

79
Standing Nude
1947
Oil on canvas
65×54.2cm
On long-term loan to Musée départemental Matisse, Cateau-Cambrésis

- 80**
Interior in Yellow and Blue
 1946
 Oil on canvas
 116×81cm
- 81**
Large Red Interior
 Spring 1948
 Oil on canvas
 146×97cm
- 82**
Verve: revue artistique et littéraire,
 no. 1 (1937), cover design by
Henri Matisse
 Periodical
 36×27cm
 Collection of Centre Pompidou, Mnam-
 Cci, Bibliothèque Kandinsky, Paris
- 83**
Verve: revue artistique et littéraire,
 no. 8 (1940), cover design by
Henri Matisse (*La Symphonie*
chromatique)
 Periodical
 36×27cm
 Collection of Centre Pompidou, Mnam-
 Cci, Bibliothèque Kandinsky, Paris
- 84**
Verve: revue artistique et littéraire,
 no. 13 (1945), cover design by
Henri Matisse
 Periodical
 36×27cm
 Collection of Centre Pompidou, Mnam-
 Cci, Bibliothèque Kandinsky, Paris
- 85**
Verve: revue artistique et
littéraire, nos. 21–22 (1948), cover
 design by **Henri Matisse**
 Periodical
 36×27cm
 Collection of Centre Pompidou, Mnam-
 Cci, Bibliothèque Kandinsky, Paris
- 86**
Verve: revue artistique et littéraire,
 no. 23 (1949), cover design by **Henri**
Matisse
 Periodical
 36×27cm
 Collection of Centre Pompidou, Mnam-
 Cci, Bibliothèque Kandinsky, Paris

7. The Cut-Outs 1931–54

- 87**
Oceania, the Sky
 Summer 1946
 Printing on linen
 Hanging printed by Zika Ascher in an
 edition of 30, no. 6/30
 177×370cm
- 88**
Oceania, the Sea
 1946
 Printing on linen
 Hanging printed by Zika Ascher in an
 edition of 30, no. 6/30
 166×380cm

- 89–108**
Jazz
 1947
 Portfolio, series of 20 plates
Pochoir on Arches wove paper, printer
 Edmond Vairel, 67/100

- 89**
The Clown
 Sheet: 42×65cm
- 90**
Sir Loyal
 Sheet: 42.3×65cm
- 91**
The Circus
 Sheet: 42.3×64.5cm
- 92**
**The Nightmare of a White
 Elephant**
 Sheet: 42.3×65.2cm
- 93**
**The Horse, the Circus Rider and
 the Clown**
 Sheet: 42×65.2cm
- 94**
The Wolf
 Sheet: 41.8×65.1cm
- 95**
Heart
 Sheet: 41.8×65.7cm
- 96**
Icarus
 Sheet: 42×65.5cm
- 97**
Forms
 Sheet: 42×65cm
- 98**
Pierrot's Burial
 Sheet: 41.8×65cm
- 99**
The Codomas
 Sheet: 42×65cm
- 100**
Swimmer in the Aquarium
 Sheet: 42×65cm
- 101**
The Sword Swallower
 Sheet: 42.5×64.5cm
- 102**
The Cowboy
 Sheet: 42×65cm
- 103**
The Knife-Thrower
 Sheet: 42×65.5cm
- 104**
Destiny
 Sheet: 42×65cm
- 105**
The Lagoon
 Sheet: 42×65cm
- 106**
The Lagoon
 Sheet: 42×65cm
- 107**
The Lagoon
 Sheet: 42×65cm
- 108**
The Toboggan
 Sheet: 42×65cm

- 109**
Pierre à feu: Les Miroirs profonds
 (Paris: Maeght, December 1947),
 cover design by **Henri Matisse**
 Periodical
 15.6×13.6cm
 Collection of Centre Pompidou, Mnam-
 Cci, Bibliothèque Kandinsky, Paris

- 110**
Georges Duthuit, *Les Fauves*
 (Geneva: Édition des Trois
 Collines, 1949), cover design by
Henri Matisse
 Book
 32.3×24cm
 Collection of Centre Pompidou, Mnam-
 Cci, Bibliothèque Kandinsky, Paris

- 111**
Henri Matisse, œuvres récentes,
1947–1948, Musée national
 d'art moderne, Paris, June 15–
 September 25, 1949 (Paris:
 Édition des musées nationaux,
 1949), cover design by **Henri**
Matisse
 Exhibition catalogue
 21.5×16cm
 Collection of Centre Pompidou, Mnam-
 Cci, Bibliothèque Kandinsky, Paris

- 112**
Henri Matisse, Musée des Beaux-
 arts, Lucerne, July 9–October 2,
 1949 (Lucerne: Musée des Beaux-
 arts, Lucerne, 1949), cover design
 by **Henri Matisse**
 Exhibition catalogue
 21×15cm
 Collection of Centre Pompidou, Mnam-
 Cci, Bibliothèque Kandinsky, Paris

- 113**
Henri Matisse: Chapelle,
peintures, dessins, sculptures,
Maison de la pensée française,
 Paris, July 5–September 24,
 1950 (Paris: Maison de la pensée
 française, 1950), cover design by
Henri Matisse
 Exhibition catalogue
 22.5×16cm
 Collection of Centre Pompidou, Mnam-
 Cci, Bibliothèque Kandinsky, Paris

- 114**
Henri Matisse, Museum
 of Modern Art, New York,
 November 13, 1951–January 13,
 1952; Cleveland Museum of Art,
 February 5–March 16, 1952; Art
 Institute of Chicago, April 1–May
 4, 1952; San Francisco Museum
 of Art, May 22–July 6, 1952 (New
 York: Museum of Modern Art,
 1951), cover design by **Henri**
Matisse
 Exhibition catalogue
 26×19.5cm
 Collection of Centre Pompidou, Mnam-
 Cci, Bibliothèque Kandinsky, Paris

- 115**
Alfred H. Barr, Jr., *Matisse: His*
Art and His Public (New York:
 Museum of Modern Art, 1951),
 cover design by **Henri Matisse**
 Book
 26×20cm
 Collection of Centre Pompidou, Mnam-
 Cci, Bibliothèque Kandinsky, Paris

- 116**
Roman, no. 1 (1951), cover design
 by **Henri Matisse**
 Periodical
 25.2×17cm
 Collection of Centre Pompidou, Mnam-
 Cci, Bibliothèque Kandinsky, Paris

- 117**
André Verdet, *Prestiges de*
Matisse (Paris: Édition Émile-
 Paul, 1952), cover design by **Henri**
Matisse
 Book
 19×14.5cm
 Collection of Centre Pompidou, Mnam-
 Cci, Bibliothèque Kandinsky, Paris

- 118**
Henri Matisse: Lithographies
rares, Berggruen Gallery, Paris,
 October 15– November 27, 1954
 (Paris: Berggruen & Cie, 1954),
 cover design by **Henri Matisse**
 Exhibition catalogue
 22×11.5cm
 Collection of Centre Pompidou, Mnam-
 Cci, Bibliothèque Kandinsky, Paris

- 119**
Henri Matisse: Papiers découpés,
 Berggruen Gallery, Paris, February
 27– March 28, 1953 (Paris:
 Berggruen & Cie, 1953), cover
 design by **Henri Matisse**
 Exhibition catalogue
 22×11.5cm
 Collection of Centre Pompidou, Mnam-
 Cci, Bibliothèque Kandinsky, Paris

- 120**
Matisse, Knokke-Le Zoute,
 Albert Plage, Grande salle des
 expositions “La Reserve,” July 12–
 August 31, 1952 (Brussels: Édition
 de la Connaissance, 1952), cover
 design by **Henri Matisse**
 Exhibition catalogue
 24.3×18.6cm
 Collection of Centre Pompidou, Mnam-
 Cci, Bibliothèque Kandinsky, Paris

- 121**
Henri Matisse: Rétrospective,
 Musée national d'art moderne,
 Paris, July 28–November 18,
 1956 (Paris: Édition des Musées
 nationaux, 1956), cover design by
Henri Matisse
 Exhibition catalogue
 27×21cm
 Collection of Centre Pompidou, Mnam-
 Cci, Bibliothèque Kandinsky, Paris

- 122**
Acrobat
 1952
 Indian ink on Arches wove paper
 105.3×74.5cm

- 123**
Woman with Amphora
 1953
 Gouache on paper, cut and pasted on
 paper, mounted on canvas
 168.5×48cm
 On long-term loan to Musée Matisse,
 Nice

- 124**
Nude with Oranges
 1953
 Indian ink and gouache on paper, cut and
 pasted on paper, mounted on canvas
 155×108cm

8. The Chapel of the Rosary, Vence 1948–51

125 Rosace of the *Virgin and Child* on the facade of the Vence Chapel [Drawing]

1951
Indian ink and gouache on paper
mounted on canvas
Dia. 151cm
Collection of Musée départemental
Matisse, Le Cateau-Cambrésis

126 Confessional door

1950
Charcoal on multiple sheets of paper
mounted on canvas
240×109cm
On long-term loan to Musée Matisse,
Nice

127 The Vence Chapel interior, the confessional door

1951
Photography, Photograph: Héléne Adant
24×18cm
Collection of Centre Pompidou, Mnam-
Cci, Bibliothèque Kandinsky, Paris

128 The Vence Chapel interior, showing Matisse's three ceramic murals (left to right): *Saint Dominic, Virgin and Child*, and *Stations of the Cross*

1951
Photography, Photograph: Héléne Adant
18×23.5cm
Collection of Centre Pompidou, Mnam-
Cci, Bibliothèque Kandinsky, Paris

129 The Vence Chapel interior, windows of the nave and transept In the foreground, the chandelier, the crucifix on the altar

1951
Photography, Photograph: Héléne Adant
12×17.8cm
Collection of Centre Pompidou, Mnam-
Cci, Bibliothèque Kandinsky, Paris

130 The Vence Chapel interior, the tabernacle and ciborium on the altar

1951
Photography, Photograph: Héléne Adant
17.6×23.5cm
Collection of Centre Pompidou, Mnam-
Cci, Bibliothèque Kandinsky, Paris

131 *L'Art sacré, nos. 11–12 (July–August, 1951)*

Periodical
26×18cm
Collection of Centre Pompidou, Mnam-
Cci, Bibliothèque Kandinsky, Paris

132 Henri Matisse, *Chapelle du rosaire des dominicaines de Vence* (Paris: Mourlot, 1951), cover design by Henri Matisse

Book
25.5×18.5cm
Collection of Centre Pompidou, Mnam-
Cci, Bibliothèque Kandinsky, Paris

133 Brother Rayssiguier's scale model in Matisse's bedroom at Le Régina

1949
Facsimile, Photograph: Héléne Adant
24×24cm
Collection of Centre Pompidou, Mnam-
Cci, Bibliothèque Kandinsky, Paris

134 Henri Matisse in his studio in Le Régina working on the first cartoon for the ceramic mural *Virgin and Child*

1949
Photography, Photograph: Héléne Adant
9×6.5cm
Collection of Centre Pompidou, Mnam-
Cci, Bibliothèque Kandinsky, Paris

135 Henri Matisse in his studio in Le Régina

1949
Photography, Photograph: Héléne Adant
8.6×6cm
Collection of Centre Pompidou, Mnam-
Cci, Bibliothèque Kandinsky, Paris

136 Henri Matisse in his studio in Le Régina

1949
Photography, Photograph: Héléne Adant
8.8×6cm
Collection of Centre Pompidou, Mnam-
Cci, Bibliothèque Kandinsky, Paris

137 Henri Matisse in his studio in Le Régina

1949
Photography, Photograph: Héléne Adant
8.8×6cm
Collection of Centre Pompidou, Mnam-
Cci, Bibliothèque Kandinsky, Paris

138 Henri Matisse in his studio in Le Régina

1949
Photography, Photograph: Héléne Adant
9×6.5cm
Collection of Centre Pompidou, Mnam-
Cci, Bibliothèque Kandinsky, Paris

139 Henri Matisse's appartement in Le Régina with the maquettes of main altar and twin windows

1950
Photography, Photograph: Héléne Adant
24.5×18cm
Collection of Centre Pompidou, Mnam-
Cci, Bibliothèque Kandinsky, Paris

140 Henri Matisse's studio in Le Régina

1950
Facsimile, Photograph: Héléne Adant
18×24cm
Collection of Centre Pompidou, Mnam-
Cci, Bibliothèque Kandinsky, Paris

141 Henri Matisse painting the rosace of the *Virgin and Child*

1950
Facsimile, Photograph: Héléne Adant
24×18cm
Collection of Centre Pompidou, Mnam-
Cci, Bibliothèque Kandinsky, Paris

142 West view of the Vence Chapel with the rosace *Virgin and Child*

1951
Photography, Photograph: Héléne Adant
24×18cm
Collection of Centre Pompidou, Mnam-
Cci, Bibliothèque Kandinsky, Paris

143 The Vence Chapel interior, the nave, with the ceramic murals *Virgin and Child* and *Stations of the Cross* (1950)

1951
Postcard, Photograph: Héléne Adant
10.5×15cm
Collection of Centre Pompidou, Mnam-
Cci, Bibliothèque Kandinsky, Paris

144 The Vence Chapel interior, the main altar in front of the *Tree of Life* twin windows, on the right: *Saint Dominic*, ceramic mural on the north wall

1951
Postcard, Photograph: Héléne Adant
10.5×15cm
Collection of Centre Pompidou, Mnam-
Cci, Bibliothèque Kandinsky, Paris

145 The Vence Chapel interior, the *Tree of Life* twin windows

1951
Postcard, Photograph: Héléne Adant
15×10.5cm
Collection of Centre Pompidou, Mnam-
Cci, Bibliothèque Kandinsky, Paris

146 Henri Matisse, *Purple Chasuble* (front), paper cut-out

1950–52
Photography, Photograph: Héléne Adant
12.6×18cm
Collection of Centre Pompidou, Mnam-
Cci, Bibliothèque Kandinsky, Paris

147 In Le Régina, Henri Matisse's models of chasuble, paper cut- outs, 1950–52, with Picasso's *Vallauris Landscape* (1951) on the mantelpiece

1951–52
Photography, Photograph: Héléne Adant
18×23.5cm
Collection of Centre Pompidou, Mnam-
Cci, Bibliothèque Kandinsky, Paris

148 The Vence Chapel viewed from the north with Vence in the background

1951
Photography, Photograph: Héléne Adant
18×24.8cm
Collection of Centre Pompidou, Mnam-
Cci, Bibliothèque Kandinsky, Paris

149 The Vence Chapel viewed from the side of the wall with the windows

1951
Photography, Photograph: Héléne Adant
24×18.5cm
Collection of Centre Pompidou, Mnam-
Cci, Bibliothèque Kandinsky, Paris

150 Henri Matisse working on the crucifix for the main altar

1950
Photography, Photograph: Héléne Adant
30×23cm
Collection of Centre Pompidou, Mnam-
Cci, Bibliothèque Kandinsky, Paris

151 Henri Matisse with Sister Jacques-Marie in the Vence Chapel interior

1951
Photography, Photograph: Héléne Adant
24×18cm
Collection of Centre Pompidou, Mnam-
Cci, Bibliothèque Kandinsky, Paris

152 View of the Vence Chapel interior, priest wearing the white chasuble c. 1951

Photography, Photograph: Héléne Adant
18×12.5cm
Collection of Centre Pompidou, Mnam-
Cci, Bibliothèque Kandinsky, Paris

153 Henri Matisse sitting in the Vence Chapel interior, with Brother Rayssiguier

1951
Photography, Photograph: Héléne Adant
24×18cm
Collection of Centre Pompidou, Mnam-
Cci, Bibliothèque Kandinsky, Paris

154 Chasuble [maquette, front, unrealized project]

1950–52
Gouache on paper, cut and pasted on
paper, mounted on canvas
132.6×197cm
On long-term loan to Musée
départemental Matisse, Cateau-
Cambrésis

155 Chasuble [maquette, back, unrealized project]

1950–52
Gouache on paper, cut and pasted on
paper, mounted on canvas
126×197.5cm
On long-term loan to Musée
départemental Matisse, Cateau-
Cambrésis